

尺寸 Dimension	$\Phi=18.0\pm 0.2\text{mm}$; $H=65.4\pm 0.2\text{mm}$	
重量 Weight	43g	
标称电压 Nominal Voltage	3.6V	
标称容量 Nominal Capacity	1,500mAh (23 \pm 2 $^{\circ}$ C, 1C恒流放电至电压2.75V)	
最小容量 Minimum Capacity	1,450mAh (23 \pm 2 $^{\circ}$ C, 1C恒流放电至电压2.75V)	
标准充电条件 (推荐) Standard Charge Method (Recommend)	1C恒流充电到4.2V, 4.2V恒压充电至电流下降到0.05C Charge at 1C constant current (CC) until the voltage reaches 4.2V, then constant voltage (CV, 4.2V) charge till charge current decline to 0.05C.	
最大持续放电电流 Max. Continuous Discharging Current	30A	
循环寿命 Cycle Life	500次 (23 \pm 2 $^{\circ}$ C, 3C充电/15C放电, 100%DOD, 容量80%) 500 Cycles (23 \pm 2 $^{\circ}$ C, 3Ccharge/15C discharge, 100%DOD, Capacity 80%)	
内阻 Internal Impedance	15m Ω	
充电电压 Charge Voltage	4.2V	
推荐温度范围 Recommend Temperature Range	充电 Charge	0 - +45 $^{\circ}$ C
	放电 Discharge	-25 - +55 $^{\circ}$ C
	储存 Storage	-20 - +35 $^{\circ}$ C

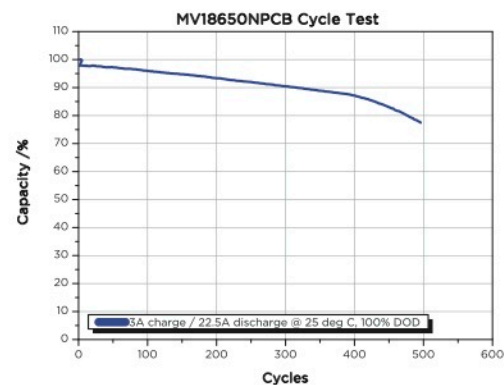
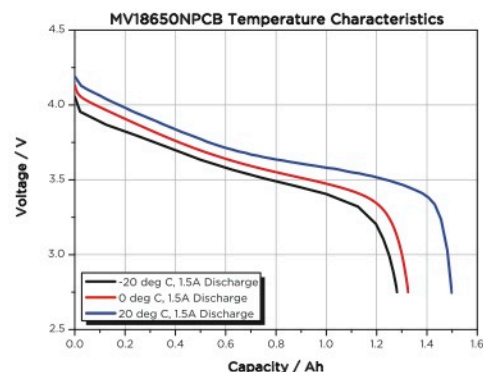
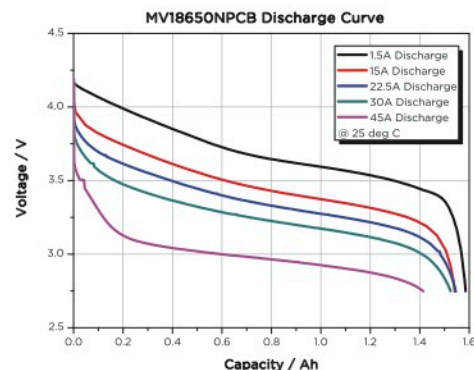
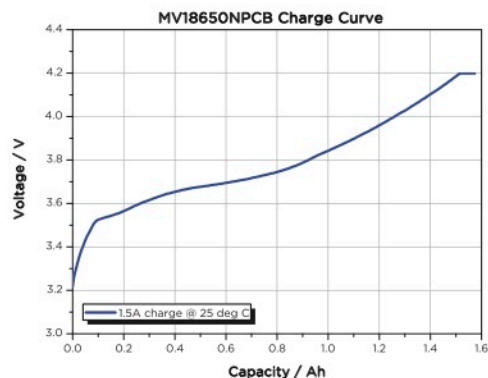
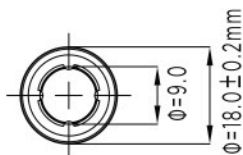
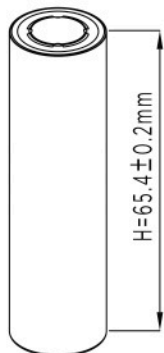

美国总部
12603 Southwest Freeway, Suite 210
Stafford, Texas 77477 USA
Telephone: +1 281 491 9505
Fax: +1 281 491 9520

China Operations
No. 2198, Hongfeng Road, Huzhou, Zhejiang
313000, P.R. China
Telephone: +86 572 275 6888
Fax: +86 572 275 6889

中国
中国浙江省湖州市红丰路2198号
邮编 313000
电话 (0572) 275 6888
传真 (0572) 275 6889

*本单页所述技术参数及图形仅供参考, 认证情况与技术参数的调整恕不另行通知, 请联系我们了解最新产品技术参数。
All the technical parameters, diagram and pictures on this paper are for customer reference only, we will NOT notify any adjustments on this paper separately. Please contact us for the most updated products specification.